

1982-1987 G47 SHEET METAL/FRONT END

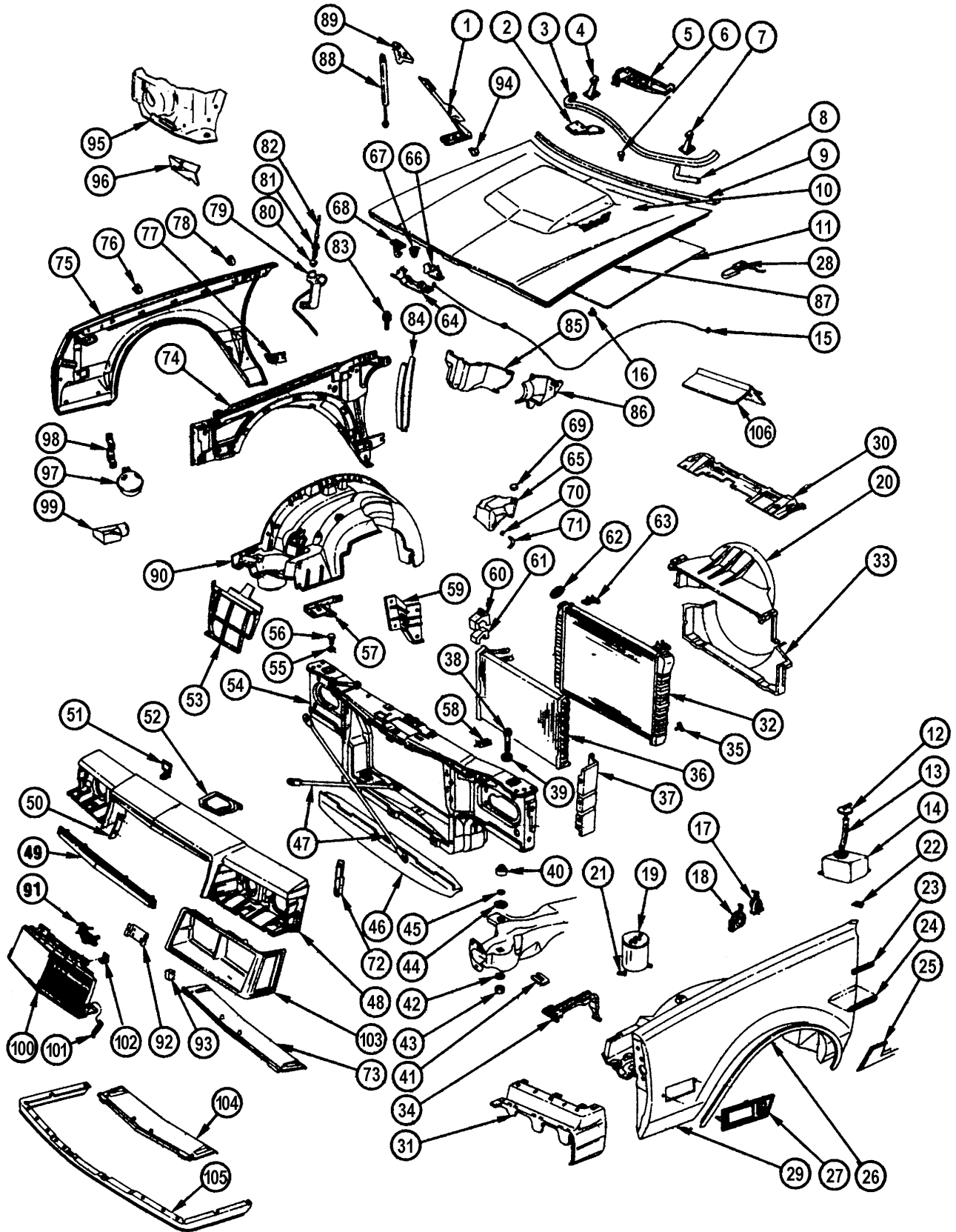

1982-1987 G47 SHEET METAL/FRONT END

1.	8.015	HINGE , HOOD-LH	14064325
	8.015	HING ASM , HOOD-RH	14064326
2.	10.156	BRACKET , NOZZLE MT	25519928
3.	12.801	LACE , HOOD EDGE	20255857
4.	10.156	NOZZLE , WSWA-RH	25508913
5.	12.800	SCREEN , MOD AIR INL	10018270
6.	8.024	BUMPER , HOOD	371945
7.	10.156	NOZZLE , WSWA-LH	25508913
8.	8.962	HOSE , (5/32" ID)(BULK)	
9.	8.055	MOLDING , HOOD RR	25505704
10.	8.055	PLATE , "3.8 LITER TURBO" (1982-83)	25505658
	8.055	PLATE , "3.8I SFI TURBO" (1984-87)	25519633
11.	8.021	INSULATOR , HD ("BUICK TURBOCHARGED")	25525977
12.	10.154	CAP , WSWA SOLV CNTNR	25526691
13.	10.154	FILTER , WSWA RES	3986821
	8.962	HOSE (7/32") (BULK)	
14.	10.154	CONTAINER , WSWA SOLV	25506641
15.	8.045	CONTROL , HOOD LAT	20429339
16.	8.934	RETAINER , HOOD INSUL	
17.	2.810	HORN , HI NOTE (A)	1892164
18.	2.810	HORN , LOW NOTE (F)	1892163
19.	3.130	CANISTER , FUEL VAPOR (SEE 3-224)	
20.	1.277	SHROUD , RAD FAN UPR	25505058
21.	8.950	CLIP , (SAE #1060, #1070)	554665
22.	8.132	MOLDING , F/FDR UPR	
23.	8.147	PLATE , "SPORTCOUPE" (1982)	1259602
	8.147	PLATE , "T-TYPE" (LM9/LC2) (1983-86)	25516596
	8.147	EMBLEM , F/FDR (TURBO 6)(LM9)(1983-84)	25513264
24.	8.132	MOLDING , F/FDR	12305402
25.	8.304	MOLDING , RKR PNL-RH	25505974
	8.304	MOLDING , RKR PNL-LH	25505975
26.	8.132	MOLDING , F/FDR WHL OPG-RH (EXC B71)	25506596
	8.132	MOLDING , F/FDR WHL OPG-LH (EXC B71)	25506597
	8.132	MOLDING , F/FDR WHL OPG-RH (BLACK)(B71)	25519950
	8.132	MOLDING , F/FDR WHL OPG-LH (BLACK)(B71)	25519951
27.	2.593	BEZEL , COR LP-RH	25511790
	2.593	BEZEL , COR LP-LH	25511791
28.	8.890	LAMP , UNDER HOOD	22529281
29.	8.130	FENDER , FRT-LH	25505891
30.	1.270	PANEL , RAD UPR MT	22506345
31.	1.263	FILLER , OTR-RH (1984 DES 1) (*1, 2)	12336188
	1.263	FILLER , OTR-LH (1984 DES 1) (*1, 2)	12336189
	1.263	FILLER , OTR-RH (1984 DES 2, 1985-87) (*1, 2) (SUPERCEDES 12336190)	25521432
	1.263	FILLER , OTR-LH (1984 DES 2, 1985-87) (*1, 2) (SUPERCEDES 12336191)	25521433
32.	1.219	RADIATOR , LC2 (SUPERCEDES 3090094)	52481580
33.	1.277	SHROUD , RAD FAN LOWER	25505059
34.	2.335	RETAINER , BAT HOLDN	22512299
35.	8.951	COCK , RAD DRAIN	
36.	9.190	CONDENSOR , A/C	3041841
37.	1.272	BAFFLE , RAD SUPPORT	1263807
38.	8.900	BOLT , HEX (M10 - 1.5 x 95)	
39.	9.023	CUSHION , RAD SUPT UPPER	377801
40.	1.270	CUSHION , RAD SUPT LWR (1982-83)	25505829
	1.270	CUSHION , RD SUPT LWR (1984-87) (9.023)	348080
41.	1.270	SHIM , (1/16") (1982-83)	3714962
42.	8.929	WASHER , (M13 X 40 X 4.3)	
43.	8.917	NUT , HEX FLG (M10 - 1.5)	
44.	8.929	WASHER , FL (M13 X 45 X 1.5)	1260895
45.	8.934	RETAINER , STUD PLT TO REINF	
46.	1.272	BAFFLE , RAD LWR AIR	25504739
47.	1.271	BRACE , RAD SUPT OPG DIA	10002352
48.	1.263	PANEL , F/END (1982 - 83)	12334983
	1.263	PANEL , F/END (1984 - 87)	25518981
49.	1.263	MOLDING , F/END PNL UPR (1982 - 83)	25505096
50.	1.263	MOLDING , F/END PNL SI-RH (1982 - 83)	25505094
	1.263	MOLDING , F/END PNL SI-LH (1982 - 83)	25505095
51.	1.303	ORNAMENT , F/END PNL (231-3) (1982 - 83)	25502681
	1.303	ORNAMENT , F/END PNL (EXC 231-3) (1982 - 83)	25505651
	1.303	ORNAMENT , F/END PNL (LM9/LC2) (1984 - 86)	25517268
	1.303	ORNAMENT , F/END PNL (EXC LM9/LC2) (1984 - 86)	25517567
52.	1.263	BRACKET , F/END PNL CTR (1982 - 83)	25504922
53.	8.155	EXTENSION , F/FDR FRT LWR-RH	25506060
	8.155	EXTENSION , F/FDR FRT LWR-LH	25506061

1982-1987 G47 SHEET METAL/FRONT END

54.	1.270	SUPPORT , RAD	14093780
55.	8.024	NUT , W/REINF PLT, HOOD BPR.....	14006598
56.	8.024	BUMPER , HOOD PNL.....	371945
57.	8.141	BRACKET , F/FDR FRT UPR-RH.....	25508524
	8.141	BRACKET , F/FDR FRT UPR-LH	25508525
58.	1.270	INSULATOR , RAD RET	371922
59.	8.153	GUSSET , W/H-RH.....	25506482
	8.153	GUSSET , W/H-LH.....	25506483
60.	9.190	BRACKET , CONDENSOR INL MT UPR.....	467321
61.	9.190	INSULATOR , A/C CONDENSOR UPR	467320
62.	1.203	CAP , RAD FILL.....	6410427
63.	1.270	INSULATOR , RAD RET	371921
64.	8.080	BRACKET , HOOD LATCH.....	467426
65.	1.240	RESERVOIR , COOLANT RECOVERY	25525470
66.	8.080	LATCH , HOOD.....	14070703
67.	8.083	SPRING , HOOD POP-UP.....	325271
68.	8.083	LATCH , HOOD SECD	25524674
69.	1.240	CAP , COOLANT RECOVERY RESVR	15630112
70.	8.948	CLAMP , HOSE	
71.	8.962	HOSE , (BULK).....	
72.	1.274	BAFFLE , SI TO FRT END PNL.....	22505356
73.	1.266	EXTENSION , RAD GRILLE-RH (1982-83).....	25505098
	1.266	EXTENSION , RAD GRILLE-LH (1982-83)	25505099
74.	8.153	PANEL , F/FDR INR-RH.....	25505882
	8.153	PANEL , F/FDR INR-LH	25505883
75.	8.130	FENDER , FRT-RH.....	25505890
76.	8.024	BUMPER , HOOD PNL SI	367493
77.	8.141	REINFORCEMENT , F/FDR LWR RR BRKT	25508864
78.	8.024	BUMPER , HOOD PNL SI	367493
79.	9.645	ANTENNA , ELEC W/C.B.....	22048605
	9.645	ANTENNA , ELEC (EXC C.B.).....	22048604
80.	9.647	BEZEL , ELEC ANT MT	25526335
81.	9.647	NUT , ANT (ELEC).....	25512547
82.	9.647	BRACKET , ELEC ANT MT.....	25509250
83.	8.015	BOLT , W/WA, HD STOP	367499
84.	8.154	INSULATOR , F/FDR TO SHROUD.....	1259346
85.	N.S.	SHIELD , A/C MODULE HEAT (82-83).....	
	8.854	SHIELD , HTR VENT MOD HT (307)(EXC A.C.)(1984-87).....	1261756
	9.211	SHIELD , EVAP & BLO MOD HEAT (231)(1984-85).....	25519028
	8.854	SHIELD , HTR BLO MD HT (EXC A.C.).....	25523185
	9.211	SHIELD , HTR & EVAP & BLO MDL (3.8-7)(W/A.C.)(1986-87)	25526953
86.	8.854	SHIELD , HTR BLO MD HT (EXC A.C.).....	25523185
87.	8.000	HOOD , W/TURBO	25512114
	8.000	HOOD , (EXC TURBO).....	25512115
88.	8.015	ROD , HOOD OPEN ASSIST	1259327
89.	8.015	BRACKET , OPN ASST ROD-RH.....	25506062
	8.015	BRACKET , OPN ASST ROD-LH	25506063
90.	8.153	PANEL , F/FDR W/H-RH (TURBO)(NON TURBO P/N 25526024).....	N.S.
	8.153	PANEL , F/FDR W/H-LH (TURBO).....	25525715
91.	1.303	PLATE , NAME "REGAL" (1982-83).....	1260880
	1.303	PLATE , NAME "REGAL" (1984).....	25517012
	1.303	PLATE , NAME "REGAL" (1985-86).....	25522816
92.	N.S.	PLATE , BACKING (1982-83)	
	1.303	PLATE , BACKING (1984).....	25517011
93.	8.921	NUT , (5MM).....	
94.	8.024	BUMPER , HOOD PNL SI RR	25505978
95.	15.280	INSULATOR , DASH (1982).....	560863
96.	12.804	HEATSHIELD , DASH	25506816
97.	9.281	TANK , A.C. VAC.....	10000669
98.	N.S.	BRACKET , A.C. VAC TANK (4.3V, 350N)(1982-83)	
99.	3.417	DUCT , AIR INTAKE FRT (1982).....	1257795
100.	1.266	GRILLE , RAD (1982) (1*).....	25508866
	1.266	GRILLE , RAD (1983) (1*).....	25512895
	1.266	GRILLE , RAD (EXC SPT PKG /TL6)(1984)	25515915
	1.266	GRILLE , RAD (EXC SPT PKG BX1)(1985-1986)	25526036
	1.266	GRILLE , RAD (W/SPT PKG BX1/TL6)(1984 - 1986)	25526744
	1.266	GRILLE , RAD (1987)(1*).....	25526613
101.	1.269	SPRING , RAD GRILLE RTN	25516618
102.	1.269	PLATE , RAD GRILLE HINGE PKG (1982-83)	25510380
103.	2.728	BEZEL , HDLP-RH (1982 - 83).....	25505092
	2.728	BEZEL , HDLP-LH (1982 - 83)	25505093
	2.728	BEZEL , HDLP-RH (1984-87).....	25525090
	2.728	BEZEL , HDLP-LH (1984-87).....	25525091

1982-1987 G47 SHEET METAL/FRONT END

104.	1.263	FILLER , RAD GRILLE (1982-83)	25505400
105.	1.272	DEFLECTOR , RAD AIR LWR	25518276
106.	8.021	SHIELD , HOOD SEAL HEAT	25521622

NOT SHOWN

1.055	BRACKET , ENG COOLING FAN (TO LWR RAD MTG PNL).....	25525430
1.055	FAN KIT , ELEC COOLING	22040856
1.055	MOTOR KIT , ELEC COOLING FAN.....	22062546
1.055	MOUNTING KIT , ELEC COOLING FAN (MTR TO SHRD).....	22040196
1.055	NUT , ELEC CLG FAN.....	22049535
1.055	RELAY , ENG CLG FAN (HI & LOW SPEED).....	25526984
1.055	RELAY , ENG CLG FAN SHUT OFF DELAY.....	25527402
1.055	RESISTOR KIT , ELEC CLG FAN.....	22062558
1.055	SHROUD KIT , ELEC CLG FAN.....	22049524
1.055	STUD , ENG COOLING FAN TO UPR RAD PNL	25525545
2.341	CABLE , BATTERY (NEG) 35".....	12026581
2.342	CABLE , BATTERY (POS).....	12046081
2.343	RETAINER , BAT CABLE TO FRAME	25502090

NOTE 1: PAINT TO MATCH

NOTE 2: 1984 DES 1 HAS A NOTCH ABOUT 1/2" LONG, DES 2 HAS A NOTCH THAT RUNS ACROSS THE PART